

OVERALL MASTERPLAN AIMS

The aims of the Masterplan are to;

- Protect existing indigenous vegetation and minimise environmental damage of any proposed works
- Retain cultural features
- Provide public recreational access and activities in appropriate locations
- Control vehicles at the site with effective carparking

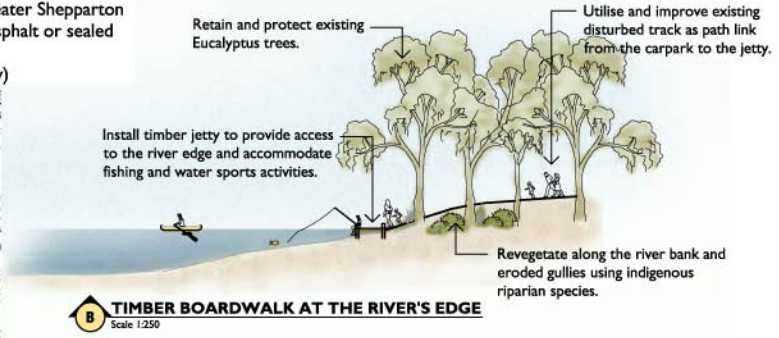
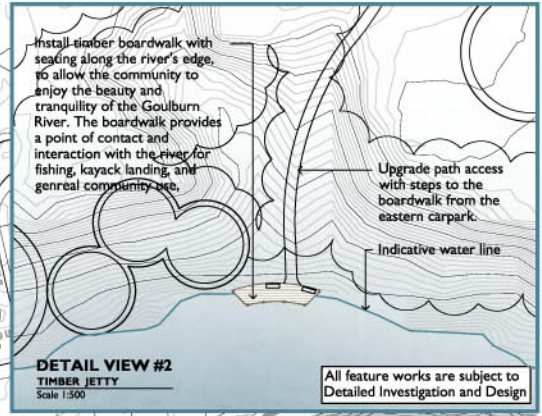
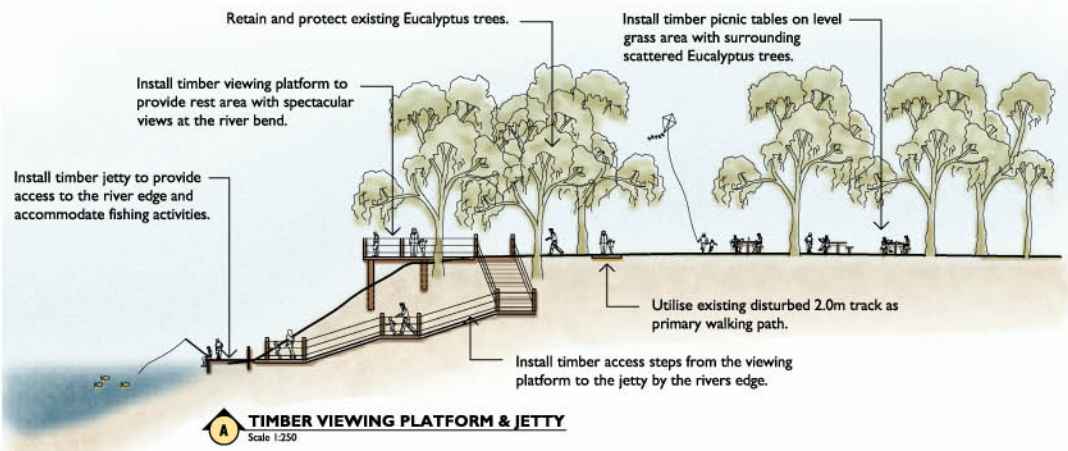
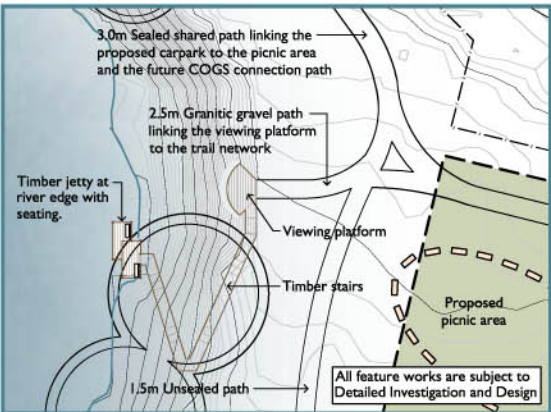
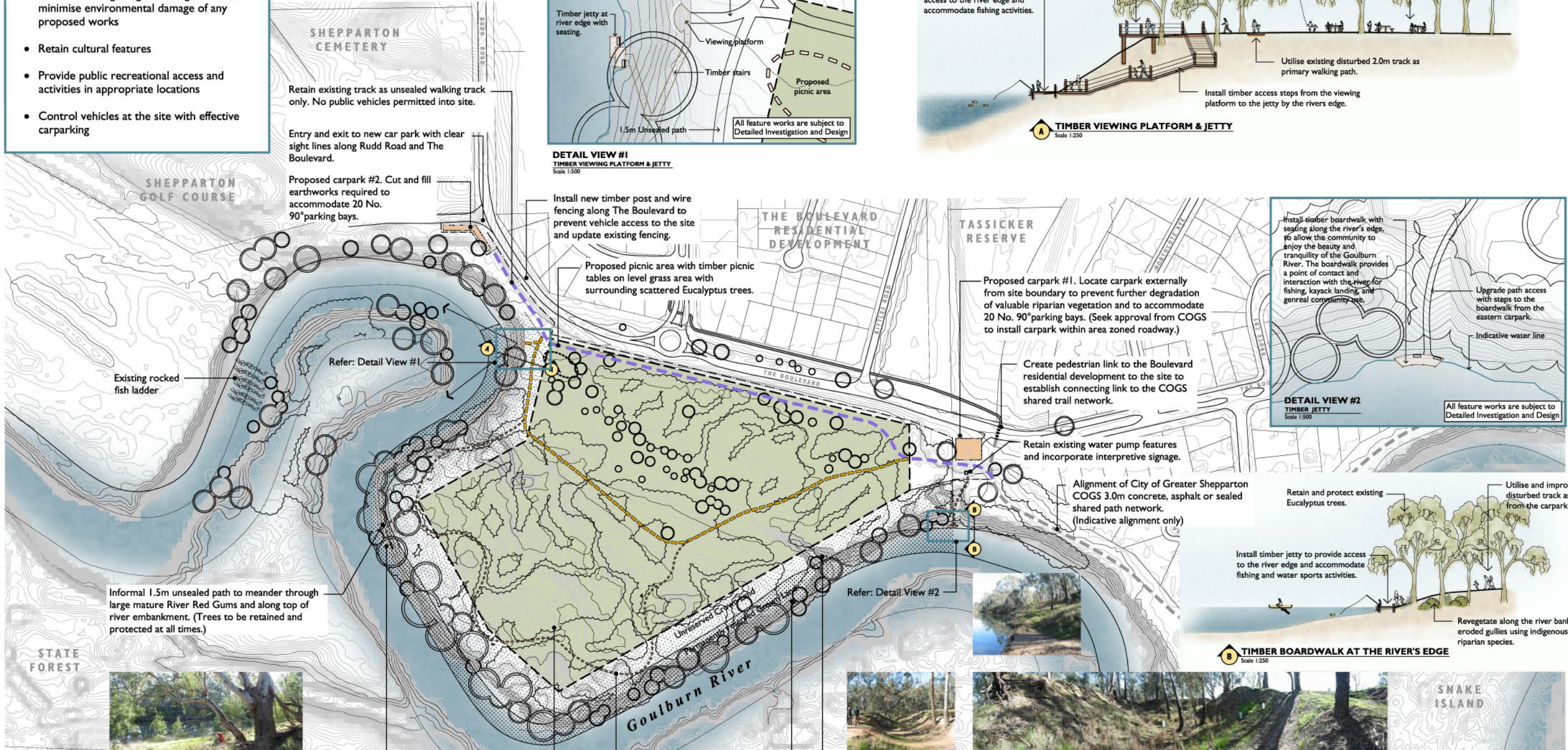

Retain existing track as unsealed walking track only. No public vehicles permitted into site.

Entry and exit to new car park with clear sight lines along Rudd Road and The Boulevard.

Proposed carpark #2. Cut and fill earthworks required to accommodate 20 No. 90° parking bays.

DETAIL VIEW #1
TIMBER VIEWING PLATFORM & JETTY
Scale 1:500

A TIMBER VIEWING PLATFORM & JETTY
Scale 1:250

DETAIL VIEW #2
TIMBER JETTY
Scale 1:500

B TIMBER BOARDWALK AT THE RIVER'S EDGE
Scale 1:250

Existing rock fish ladder

Refer: Detail View #1

Install new timber post and wire fencing along The Boulevard to prevent vehicle access to the site and update existing fencing.

Proposed picnic area with timber picnic tables on level grass area with surrounding scattered Eucalyptus trees.

Proposed carpark #1. Locate carpark externally from site boundary to prevent further degradation of valuable riparian vegetation and to accommodate 20 No. 90° parking bays. (Seek approval from COGS to install carpark within area zoned roadway.)

Create pedestrian link to the Boulevard residential development to the site to establish connecting link to the COGS shared trail network.

Retain existing water pump features and incorporate interpretive signage.

Alignment of City of Greater Shepparton COGS 3.0m concrete, asphalt or sealed shared path network. (Indicative alignment only)

Informal 1.5m unsealed path to meander through large mature River Red Gums and along top of river embankment. (Trees to be retained and protected at all times.)

Refer: Detail View #2

Install seating along flat bank edge, to provide a quiet peaceful rest area with stunning views of the river landscape.

Undertake earthworks as required to fill existing cuts through site. Revegetate area with indigenous ground cover species to discourage continuous erosion resulting from informal recreational activities.



Typical views across the site of Red Gum woodland environment.



Utilise existing disturbed track network to prevent further fragmentation of the site.



Closure of existing informal tracks along the top of the river bank, to prevent further erosion of river embankment.

DRAWING KEY		
PATH TYPES	PROPOSED FEATURES	EXISTING FEATURES
Site site boundary	Proposed carpark footprint	Mature River Red Gums
Proposed 3.0m sealed shared path	Proposed picnic areas	Overstorey vegetation
Proposed 2.5m granitic gravel path	Proposed timber jetty	Post and wire fencing
Proposed 1.5m unsealed path	Proposed viewing platform	200m Contours
Existing 2.5m sealed path	Proposed timber steps	Unreserved Crown Land (indicative only)
COGS shared path alignment (Indicative Only)	Proposed timber seat	Permanently reserved Crown Land (indicative only)
	Proposed vehicle control bollards	

